

# AHL Type

## 90° 雙頭橫向銑頭

## 90° Double Head Angle Head

- 輕量化設計，適用於鑽銑加工及攻牙加工。
- 自動刀庫換刀加工，量化生產必備工具。
- 環抱型定位塊設計，可 360° 旋轉調整加工角度，並加強鎖固力道及加工角度精確性。

- Compact and lighter body design is suitable for drilling, milling, and tapping application.
- Can be automatic tool changed. Increases productivity.
- Enclosed Positioning Pin: Cutting Direction can be adjusted from 0~360 degrees. It allows higher clamping torque and cutting direction could remain during the machining.

內孔偏擺	0.002mm
材質	航太用鋁合金 & 合金鋼
轉速	最高 6000 RPM
扭力	最大 25 Nm
鑽孔	最大 16 mm
攻牙	最大 M12
齒輪比	1 : 1
適用主軸	BT, SK(ISO), CAT
標準配件	開口扳手、ER 內牙扳手
出力軸轉向	正轉 / 反轉

Run-out	0.002mm
Material	Aerospace Alu. Alloy & Alloy Steel
R.P.M.	Max. 6000 RPM
Torque	Max. 25 Nm
Drilling	Max. 16 mm
Tapping	Max. M12
Gear Ratio	1 : 1
Spindle Type	BT, SK(ISO), CAT
Standard Accessory	Open End Wrench, ER I.N. Wrench
Output Rotation	Same as / Reverse to Input Rotation

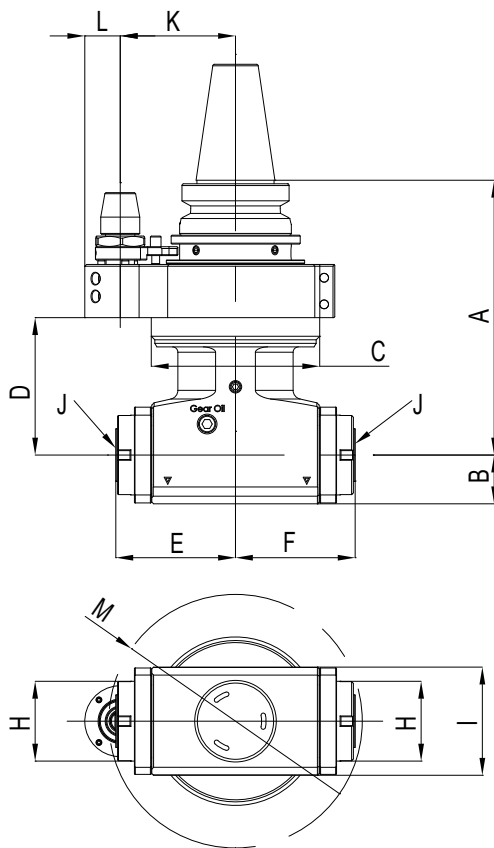

**思誠資源**  
WWW.SCZY.COM  
机床附件提供商



Unit : mm

Model NO.	A	B	C	D	E	F	H	I	J	K	L	M	N.W.(KG)
AHL-BT40-H1.65/80/110	155	27.5	95	77.5	67.5	67.5	45	61	1~16 (ER25 I.N)	65/80/110	20	143	6.6
AHL-SK40-H1.65/80/110	160.5	27.5	95	77.5	67.5	67.5	45	61	1~16 (ER25 I.N)	65/80/110	20	143	6.6
AHL-CAT40-H1.65/80/110	160.5	27.5	95	77.5	67.5	67.5	45	61	1~16 (ER25 I.N)	65/80/110	20	143	6.6
AHL-BT50-H1.80/110	162	27.5	95	77.5	67.5	67.5	45	61	1~16 (ER25 I.N)	80/110	20	143	9.1
AHL-SK50-H1.80/110	162	27.5	95	77.5	67.5	67.5	45	61	1~16 (ER25 I.N)	80/110	20	143	9.1
AHL-CAT50-H1.80/110	162	27.5	95	77.5	67.5	67.5	45	61	1~16 (ER25 I.N)	80/110	20	143	9.1

※ I.N. : 內牙 Internal Nut